



# MOTORTRONICS™

*Solid State AC Motor Control*

## ***MEDIUM VOLTAGE TRANSFORMERS***



C **UL**® US



**5kV**  
CLASS

**7kV**  
CLASS

**12kV**  
CLASS

**15kV**  
CLASS

**PATENT 7,737,814**

# MEDIUM VOLTAGE TRANSFORMERS

## INDOOR VOLTAGE TRANSFORMERS



**MODEL 3PT3-60** Accuracy Class: 0.3 WX, 0.6M, 1.2Y at 100% rated voltage with 120V base ANSI burden.

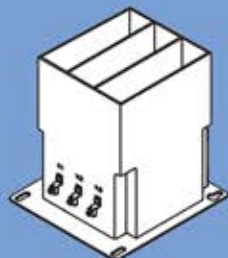

GROUP	CATALOG NO. FUSES	CATALOG NO. FUSE CLIPS ONLY	RATED PRIMARY VOLTAGE	RATIO	SUGGESTED FUSE RATING
1	3PT3-60-841FFF	3PT3-60-841CCC	840	7:1	1.0E
1	3PT3-60-122FFF	3PT3-60-122CCC	1200	10:1	1.0E
1	3PT3-60-242FFF	3PT3-60-242CCC	2400	20:1	0.5E
2	3PT3-60-332FFF	3PT3-60-332CCC	3300	30:1	0.5E
2	3PT3-60-422FFF	3PT3-60-422CCC	4200	35:1	0.5E
2	3PT3-60-482FFF	3PT3-60-482CCC	4800	40:1	0.5E

5kV Class  
15kV Class

**PTG3-1-60 & PTG3-2-60** Accuracy Class: 0.3 WXY, 0.6M, 1.2Z at 100% rated voltage with 120V based ANSI burden.

Insulation Level: 5.6 kV, 60kV BIL Full Wave 0.3 WX, 0.6M, 1.2Y at 58% rated voltage with 69.3V based ANSI burden.

**PATENT**

**PTW3-1-60 & PTW3-2-60** Accuracy Class: 0.3 WXY, 1.2Z at 100% rated voltage with 120V based ANSI burden.

Insulation Level: 5.6 kV, 60kV BIL Full Wave 0.6 WX, 1.2MY at 58% rated voltage with 69.3V based ANSI burden.

**7,737,814**

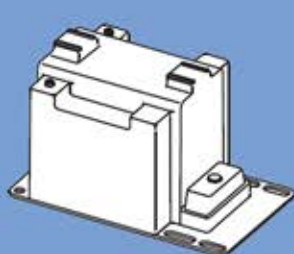

UNFUSED

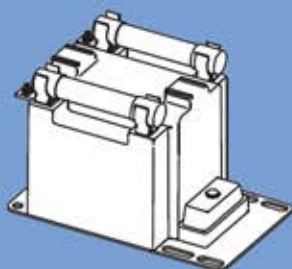

TWO FUSE

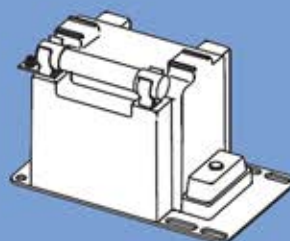

ONE FUSE

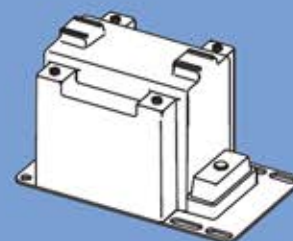

SWITCHGEAR STYLE

GROUP	TWO BUSHING			CATALOG NUMBERS			
	PRIMARY VOLTAGE	RATIO	SECONDARY VOLTAGE	UNFUSED	FUSES	FUSE CLIPS ONLY	SWITCHGEAR STYLE
				PT*3-2-60-242	PT*3-2-60-242FF	PT*3-2-60-242CCS or CCL	PT*3-2-60-242SS
1	2400	20:1	120	PT*3-2-60-242	PT*3-2-60-242FF	PT*3-2-60-242CCS or CCL	PT*3-2-60-242SS
2	3300	30:1	110-50Hz	PT*3-2-60-332	PT*3-2-60-332FF	PT*3-2-60-332CCS or CCL	PT*3-2-60-332SS
2	4200	35:1	120	PT*3-2-60-442	PT*3-2-60-442FF	PT*3-2-60-442CCS or CCL	PT*3-2-60-442SS
2	4800	40:1	120	PT*3-2-60-482	PT*3-2-60-482FF	PT*3-2-60-482CCS or CCL	PT*3-2-60-482SS

GROUP	ONE BUSHING			R <sub>FL</sub>	CATALOG NUMBERS		
	PRIMARY VOLTAGE	RATIO	SECONDARY VOLTAGE		FUSES	FUSE CLIPS ONLY	SWITCHGEAR STYLE
					PT*3-1-60-242F	PT*3-1-60-242CS or CL	PT*3-1-60-242S
4A	2400	20:1	120	230	PT*3-1-60-242F <td>PT*3-1-60-242CS or CL <td>PT*3-1-60-242S</td> </td>	PT*3-1-60-242CS or CL <td>PT*3-1-60-242S</td>	PT*3-1-60-242S
4B	4200	35:1	120	230	PT*3-1-60-332F <td>PT*3-1-60-332CS or CL <td>PT*3-1-60-332S</td> </td>	PT*3-1-60-332CS or CL <td>PT*3-1-60-332S</td>	PT*3-1-60-332S
4B	4800	40:1	120	230	PT*3-1-60-442F <td>PT*3-1-60-442CS or CL <td>PT*3-1-60-442S</td> </td>	PT*3-1-60-442CS or CL <td>PT*3-1-60-442S</td>	PT*3-1-60-442S

Substitute \* with 'G' or 'W' for correct catalog number.

## MEDIUM VOLTAGE CONTROL POWER TRANSFORMERS

7.2kV Class

**MODEL CPT3-60-2**

Insulation Level: 6.9 kV, 60kV BIL Full Wave

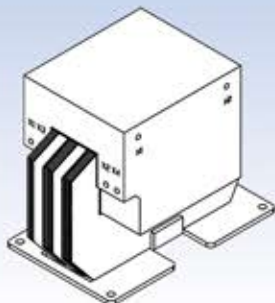

CATALOG NO	PRIMARY VOLTAGE	RATIO AT 110V "-5"	RATIO AT 120V "-6"	SECONDARY VOLTAGE "-5" Model	SECONDARY VOLTAGE "-6" Model	FREQUENCY Hz	THERMAL RATING
CPT3 60 2 2400 -*	2400	21.81	20.00	110/220	120/240	50/60	2.0 kVA
CPT3 60 2 3300 -*	3300	30.00	27.50	110/220	120/240	50/60	2.0 kVA
CPT3 60 2 4160 -*	4160	37.81	34.66	110/220	120/240	50/60	2.0 kVA
CPT3 60 2 4800 -*	4800	43.63	40.00	110/220	120/240	50/60	2.0 kVA
CPT3 60 2 5000 -*	5000	45.45	41.66	110/220	120/240	50/60	2.0 kVA
CPT3 60 2 5500 -*	5500	50.00	45.83	110/220	120/240	50/60	2.0 kVA
CPT3 60 2 6000 -*	6000	54.54	50.00	110/220	120/240	50/60	2.0 kVA
CPT3 60 2 6600 -*	6600	60.00	55.00	110/220	120/240	50/60	2.0 kVA
CPT3 60 2 6900 -*	6900	62.72	57.50	110/220	120/240	50/60	2.0 kVA

Substitute \* with '5' 110/120V or '6' 120/240V for correct catalog number.

**Motortronics / Phasetronics**

1600 Sunshine Drive

Tel: 727.573.1819 or 888.767.7792

E-mail: sales@motortronics.com

Clearwater, Florida 33765

Fax: 727.573.1803 or 800.548.4104

www.motortronics.com

PN: VT-MV071514