

CURRENT TRANSFORMER

Model 137

Window Diameter 5.50"

Application:
Relaying and Metering

Frequency:
50 - 400 Hz

Insulation Level:
600 Volts, 10 kv BIL full wave

- Terminals are brass screws No. 10 - 32 with one flatwasher, lockwasher and regular nut.
- Multi-ratios available on request.
- Order mounting bracket kit No. CR-CL separately.
- Approximate weight: 50 lbs



E228202

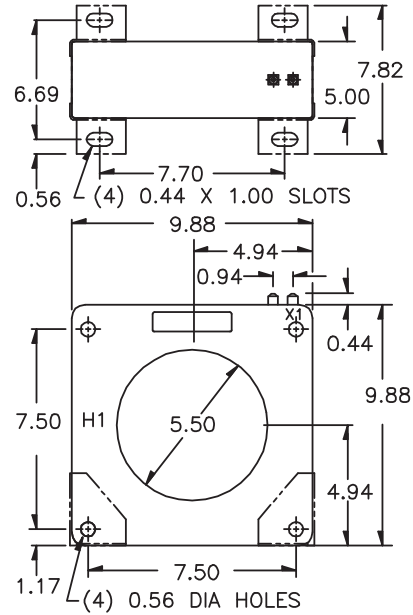
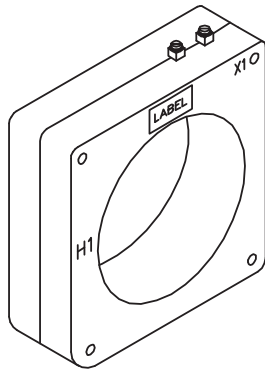

EXCITATION CURVE

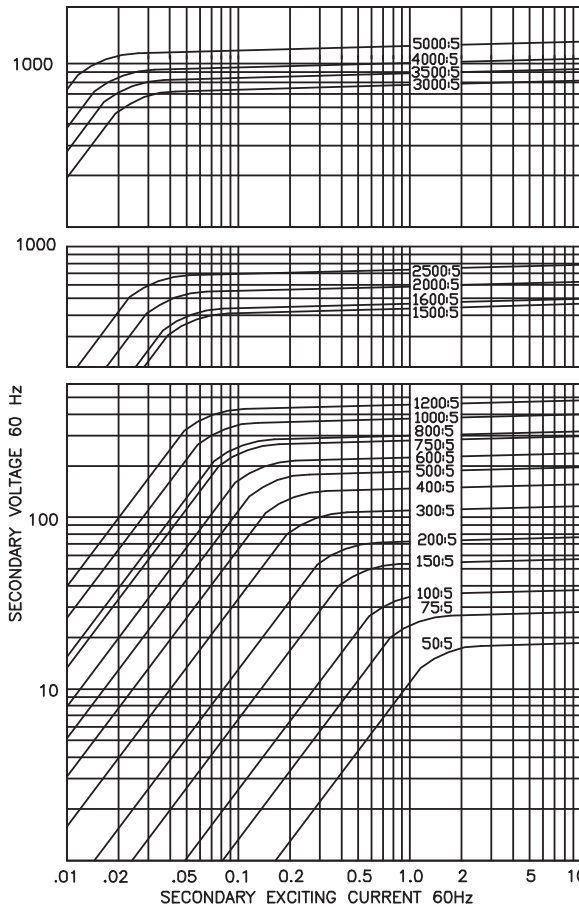

CATALOG NUMBER	CURRENT RATIO	RELAY CLASS	ANSI METERING CLASS AT 60 Hz					SECONDARY WINDING RESISTANCE (OHMS @ 75 °C)	CONTINUOUS THERMAL RATING FACTOR	
			B0.1	B0.2	B0.5	B0.9	B1.8		@30°C	@55°C
137-500	50:5	C10	2.4	4.8	-	-	-	0.019	2.0	2.0
137-750	75:5	C20	1.2	2.4	4.8	-	-	0.029	2.0	2.0
137-101	100:5	C20	1.2	1.2	2.4	4.8	-	0.039	2.0	2.0
137-151	150:5 *	C20	0.6	0.6	1.2	2.4	4.8	0.058	2.0	2.0
137-201	200:5 *	C50	0.3	0.6	1.2	1.2	2.4	0.078	2.0	2.0
137-251	250:5 *	C50	0.3	0.3	0.6	1.2	1.2	0.097	2.0	2.0
137-301	300:5 *	C100	0.3	0.3	0.6	0.6	1.2	0.116	2.0	2.0
137-401	400:5 *	C100	0.3	0.3	0.3	0.3	0.6	0.155	2.0	2.0
137-501	500:5 *	C100	0.3	0.3	0.3	0.3	0.6	0.194	2.0	2.0
137-601	600:5 *	C200	0.3	0.3	0.3	0.3	0.3	0.233	2.0	2.0
137-751	750:5 *	C200	0.3	0.3	0.3	0.3	0.3	0.291	2.0	2.0
137-801	800:5 *	C200	0.3	0.3	0.3	0.3	0.3	0.390	2.0	2.0
137-102	1000:5 *	C200	0.3	0.3	0.3	0.3	0.3	0.488	2.0	1.5
137-122	1200:5 *	C400	0.3	0.3	0.3	0.3	0.3	0.585	2.0	1.5
137-152	1500:5 *	C400	0.3	0.3	0.3	0.3	0.3	0.678	1.5	1.33
137-162	1600:5 *	C400	0.3	0.3	0.3	0.3	0.3	0.723	1.5	1.33
137-202	2000:5 *	C400	0.3	0.3	0.3	0.3	0.3	0.903	1.5	1.0
137-252	2500:5 *	C400	0.3	0.3	0.3	0.3	0.3	1.129	1.5	1.0
137-302	3000:5 *	C400	0.3	0.3	0.3	0.3	0.3	1.279	1.33	1.0
137-352	3500:5 *	C400	0.3	0.3	0.3	0.3	0.3	1.492	1.0	0.8
137-402	4000:5 *	C400	0.3	0.3	0.3	0.3	0.3	2.136	1.0	0.8
137-502	5000:5 *	C400	0.3	0.3	0.3	0.3	0.3	4.199	0.6	0.3