



**Current Transformer
Technologies LTD**



Current Transformer

Model 2

rev 12022025

CERTIFICATIONS:



E228202



223647



ISO 9001

QUALITY
MANAGEMENT

APPLICATION:

Generally for Ammeter use only

FREQUENCY:

50-400 Hz.

INSULATION LEVEL:

600 Volts. 10 kV BIL. full wave

WINDOW:

1.00", 1.05", 1.13"

APPROXIMATE WEIGHT:

0.5 lbs.

CONNECTIONS:

-Flexible Leads are UL 1015 105°C, CSA approved #16 AWG, 24" long

-Non-standard length to be specified

-Terminals are brass studs No. 8-32 UNC with one flat washer, lock washer, and regular nut

-SHT and SFT case style also available as SHL or SFL with Leads

-Mounting bracket for Model 2SHT: 2SHT-KIT



2SHT



2SFT



2RL



2DRL

Model	2SHT	2SFT	2RL	2DRL
Window Size	1.13	1.13	1.05	1.00
Width	2.40	2.40	2.46	2.42
Height	2.71	2.68	2.46	2.42
Depth	0.95	2.00	1.05	1.75

MODEL 2

Window Diameter 1.00", 1.05", 1.13"

Approximate weight: 0.5 lbs.

CATALOG NUMBER	CURRENT RATIO	MODELS 2SFT, 2SHT, 2RL		MODEL 2DRL	
		ACCURACY AT 60 HZ	BURDEN VA AT 60 HZ	ACCURACY AT 60 HZ	BURDEN VA AT 60 HZ
2**-250	25:5	-	-	± 5%	1
2**-500	50:5	± 4%	1	± 2%	1.5
2**-600	60:5	± 3%	2	± 2%	2
2**-750	75:5	± 3%	2	± 2%	3
2**-800	80:5	± 2%	2	± 2%	4
2**-101	100:5	± 1%	2	± 1%	5
2**-121	120:5	± 1%	2.5	± 1%	5
2**-1250	125:5	± 1%	2.5	± 1%	5
2**-151	150:5	± 1%	4	± 1%	8
2**-181	180:5	± 1%	4	± 1%	10
2**-201	200:5	± 1%	4	± 1%	10
2**-251	250:5	± 1%	6	± 1%	12.5
2**301	300:5	± 1%	8	± 1%	15
2**-331	330:5	± 1.2%	10	± 1%	17.5

NOTE: When ordering, Prefix Cat. No. With model designation required, i.e. 2SFT-301, 2RL-301, or 2SHT-301 or 2DRL-301

Products are manufactured in a plant whose quality management system has been certified to be in compliance with ISO 9001:2015 by NQA



2SHT

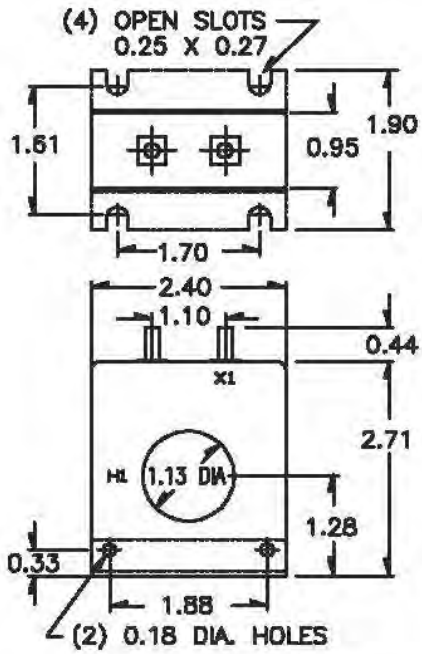

2SFT

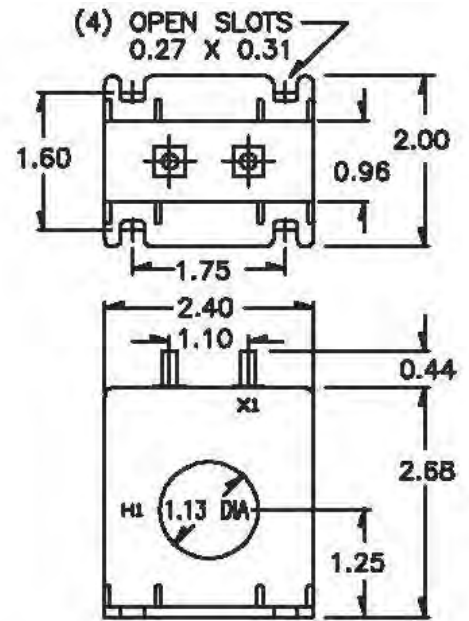

2RL

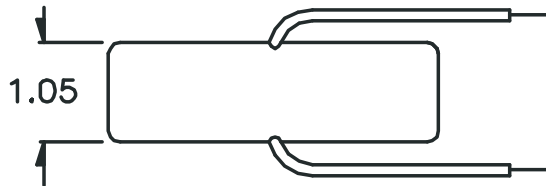

2DRL

