



**Current Transformer
Technologies LTD**



Control Power Transformer

Model CPT3-60-2

rev 11132025

CERTIFICATIONS:



APPLICATION:

To provide control power in distribution equipment and motor starters

FREQUENCY:

See below

INSULATION LEVEL:

5 kV, 60 kV BIL, full wave

THERMAL RATING:

At 30°C. amb., see below

APPROXIMATE WEIGHT:

63 lbs.

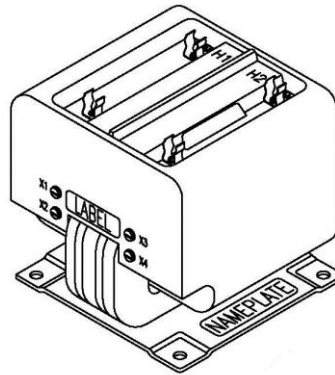

- Primary terminals are brass screws No. 10-32 with one flat washer and lockwasher.
- Secondary terminals are brass screws No. 10-32 with one flat washer and lockwasher.
- The transformer winding is vacuum encapsulated in polyurethane resin
- Plated steel mounting base
- For indoor use

| CATALOG NUMBER | PRIMARY VOLTAGE | RATIO | SECONDARY VOLTAGE | FREQUENCY | THERMAL RATING | PRIMARY FUSE |
|------------------|-----------------|--------|-------------------|-----------|----------------|--------------|
| CPT3-60-2-242FF | 2400V | 20:1 | 120/240V | 60Hz | 2.0kVA | 3E |
| CPT3-60-2-332FF | 3300V | 30:1 | 110/220V | 50Hz | 1.8kVA | 2E |
| CPT3-60-2-4161FF | 4160V | 34.7:1 | 120/240V | 60Hz | 2.0kVA | 2E |
| CPT3-60-2-482FF | 4800V | 40:1 | 120/240V | 60Hz | 2.0kVA | 2E |
| CPT3-60-2-662FF | 6600V | 60:1 | 110/220V | 60Hz | 2.0kVA | 1E |
| CPT3-60-2-722FF | 6900V | 60:1 | 120/240V | 60Hz | 2.0kVA | 1E |

*For fuse clips only, change FF to CC

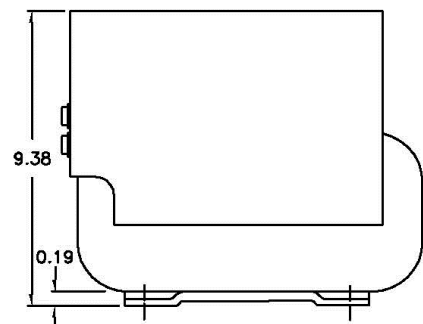
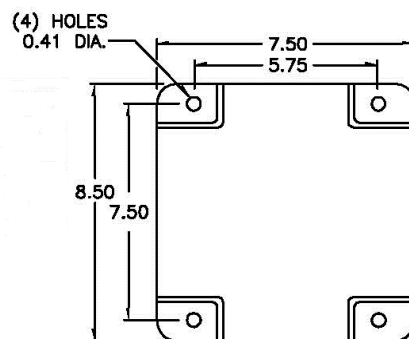
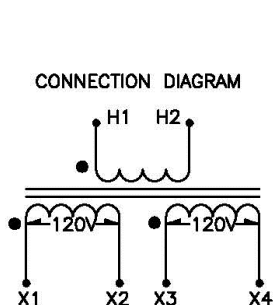
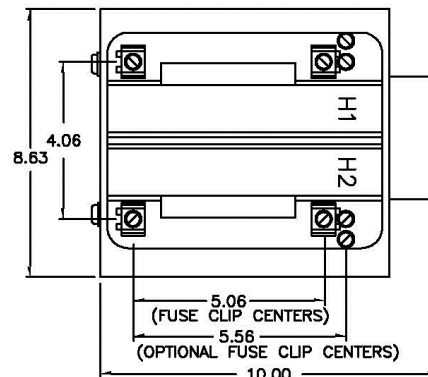
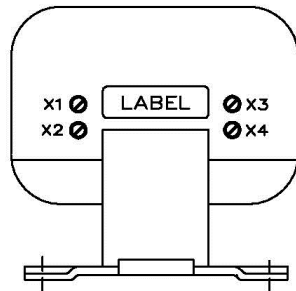

Products are manufactured in a plant whose quality management system has been certified to be in compliance with ISO 9001:2015 by NQA